



Leg Frame Join Module for Pro Tools® | S6

This document explains how to assemble Leg Frames and the Leg Frame Join Module. The Leg Frame Join Module for Pro Tools® | S6 consists of special center Legs and a mounting bracket that let you join two or more S6 Leg Frames together to form a larger system. The center Legs provide frame support with a shorter bottom foot than standard Leg Frame Legs. The bracket attaches to the Beams to join the two frames together.

If your system includes a Leg Frame Join Module, follow these instructions to assemble and join both Leg Frames. If your system does not include a Leg Frame Join Module, use the instructions for assembling a single Leg Frame found in the *S6 Installation Guide*.

⚠ *Make sure you have at least one other person available if you need to lift, turn, or move the system during and after assembly. Components and systems are heavy! Team lift, always.*

Unpack the Leg Frames

Unpack the Legs, Beams, brackets, fasteners and tools and identify the components. Figure 1 shows the components for a two-frame system.

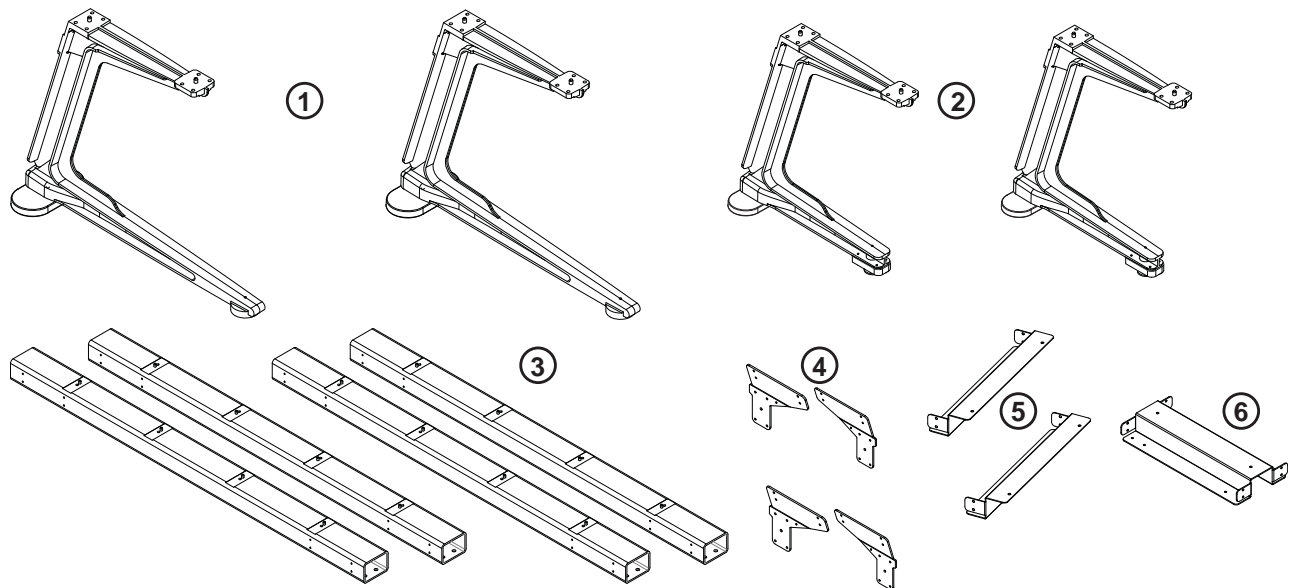

Figure 1. Leg Frame and Leg Frame Join Module components

1– Legs (2x standard)

2– Legs (2x Center)



If you are joining three frames together, there will be two standard legs and four Center legs.

3– Beams (2x per frame)

4– Back Corner Brackets (2x per frame)

5– End Brackets (2x)

6– Center Bracket (1x per pair of frames)

7– Fasteners and Tools (not shown)

Overview of Leg Frame Assembly

Figure 2 shows two assembled and joined frames, and identifies each of the following components:

Frames Left frame (A) and right frame (B). The width of your frames may differ from those shown in these instructions.

Legs Two standard Legs (C) and two center Legs (D)

End Brackets Two brackets (E), one at each end

Center Bracket (F)

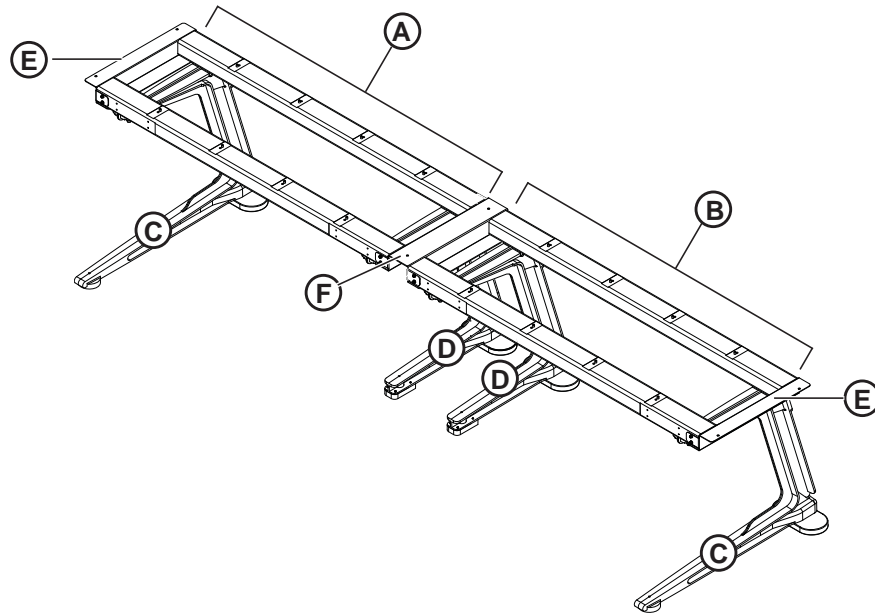

Figure 2. Two assembled frames

The basic steps for assembling Leg Frames are as follows (the remaining pages of this document provide step by step instructions):

- If you are expanding an already assembled S6 system, follow the instructions in Appendix A of the *S6 Installation Guide* to remove T-Strips, Compression and Fill Panels, modules, Side and Rear Covers, chassis and End Brackets from the existing frame. You will also have to remove one of the standard Legs and install a center Leg in its place.
- Determine which frame will be at the left (A in Figure 2) and which will be at the right (B in Figure 2).
- Assemble the frames one at a time. Each frame uses one standard Leg and one center Leg. Standard Legs are installed at the outside ends (C in Figure 2). The center Legs are installed at the ends where frames join (D in Figure 2).
- Put the first Beam across the back of the Legs, orienting it as shown in the following diagrams and securing it with the included fasteners. Do not tighten down fasteners all the way.
- Place another Beam across the front, orienting it as shown, and secure it with fasteners (do not fully tighten the fasteners).
- Attach the Back Corner Brackets (do not fully tighten the fasteners).
- Attach an End Bracket (E in Figure 2). Do not fully tighten the fasteners.
- Level the frame, then tighten all fasteners after ensuring the frame is properly aligned and level.
- Repeat to assemble the other frame, making sure to install the End Bracket on the appropriate end.
- Make sure both frames are level with each other. Adjust front and back foot height if necessary.
- Attach the Center Bracket (F in Figure 2) to the right frame, then move the left frame into position and secure it to the Center Bracket.



To simplify assembly, do not fully tighten any fasteners until all Legs, Beams, and brackets are put together and aligned. After all parts are assembled and aligned, start at one end and tighten all fasteners securely as instructed.

Assemble the First Frame

Assemble the two Leg Frames one at a time. In two-frame assemblies, each frame uses one standard Leg and one center Leg. The center Legs are installed at the ends where the frames join (at far right of the left frame, and at far left of right frame). One End Bracket is installed onto each frame.

 If you are joining three frames together, use the following instructions to assemble the two outside frames (far left and far right). For the third frame, install two Center Legs and no End Brackets.

Attaching the Back Beam

Attaching the back Beam:

1 Place one of the Beams on the floor to determine how far apart the Legs need to be. Make sure you have the standard and center Legs in the correct position depending on whether you are assembling the left or right frame (Figure 3 shows Leg and Beam orientation for the left frame).

 Have someone help hold the components while you position the Beams on the Legs and attach the fasteners.

- 2 Attach the back Beam by doing the following (see Figure 3):
- Put the first Beam across the back of the Legs. Align the holes in the underside of the Beams with the pins on the top of the Legs. Be sure to orient the back Beam so that the pins on the *top* of the Beam are closer to the center of the frame.
 - Using four fasteners and washers (included) per mount, secure the Beam at each end. Do not tighten down fasteners all the way until both Beams and both Back Corner Brackets are in place.

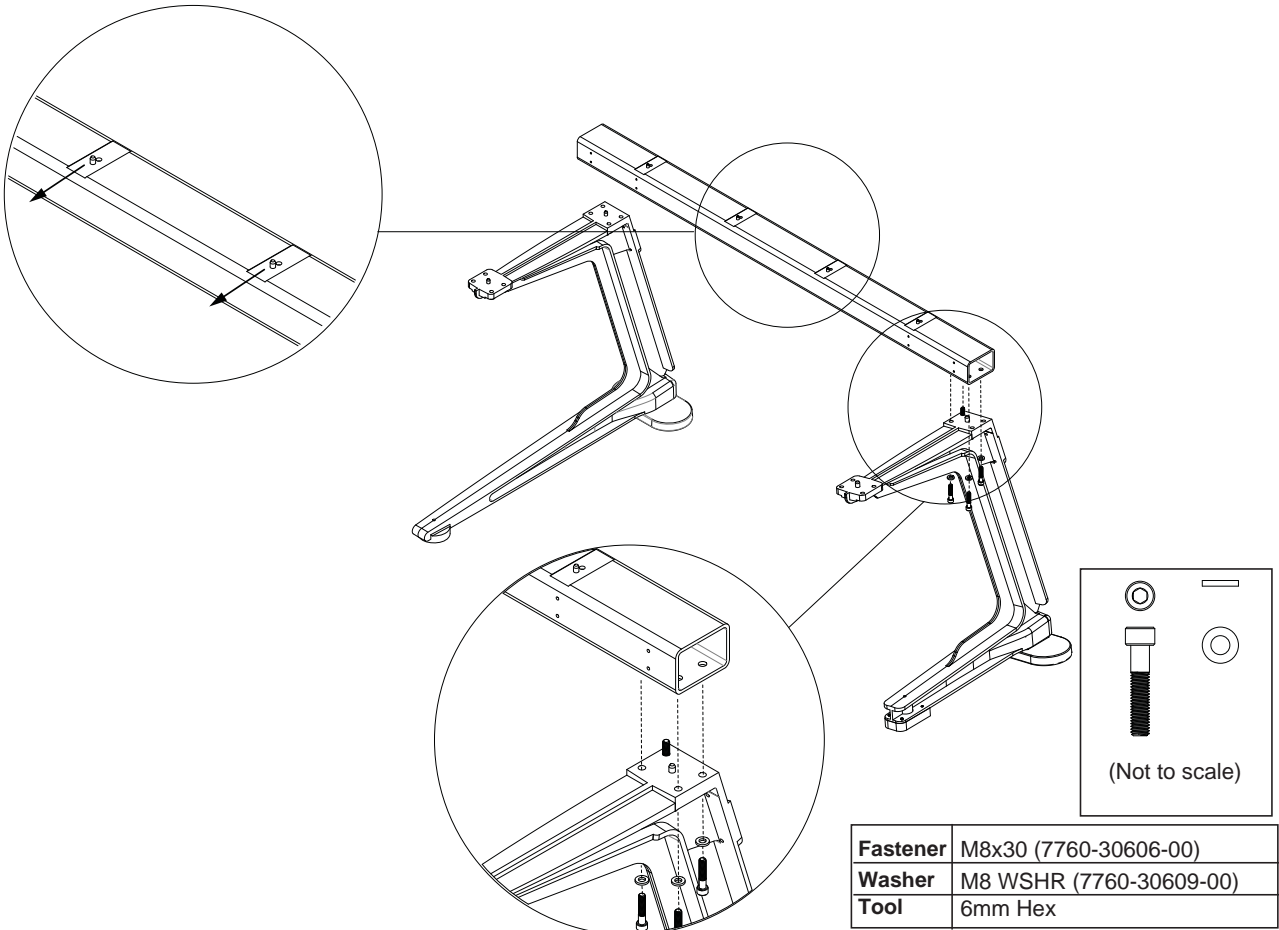

Figure 3. Attaching the back Beam to the Legs for the left frame (orientation of top pins shown at upper left)

3 Make sure the Beam sits flat on the top of the Legs as shown in Figure 4. If necessary, move the Legs in or out.

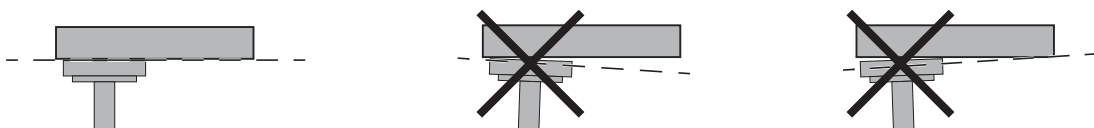

Figure 4. Back view showing correct alignment of Beam on Leg (at left), and incorrect alignment (middle, and right)

Attaching the Front Beam

To attach the front Beam:

- 1 Align the holes in the underside of the Beam with the pins on the top of the Legs. Be sure to orient the front Beam so that the pins on the *top* of the Beam are closer to the center of the frame.
- 2 Using four fasteners and washers (included) per mount, attach the Beam across the front of the Legs as shown in Figure 5. Do not tighten the fasteners fully.

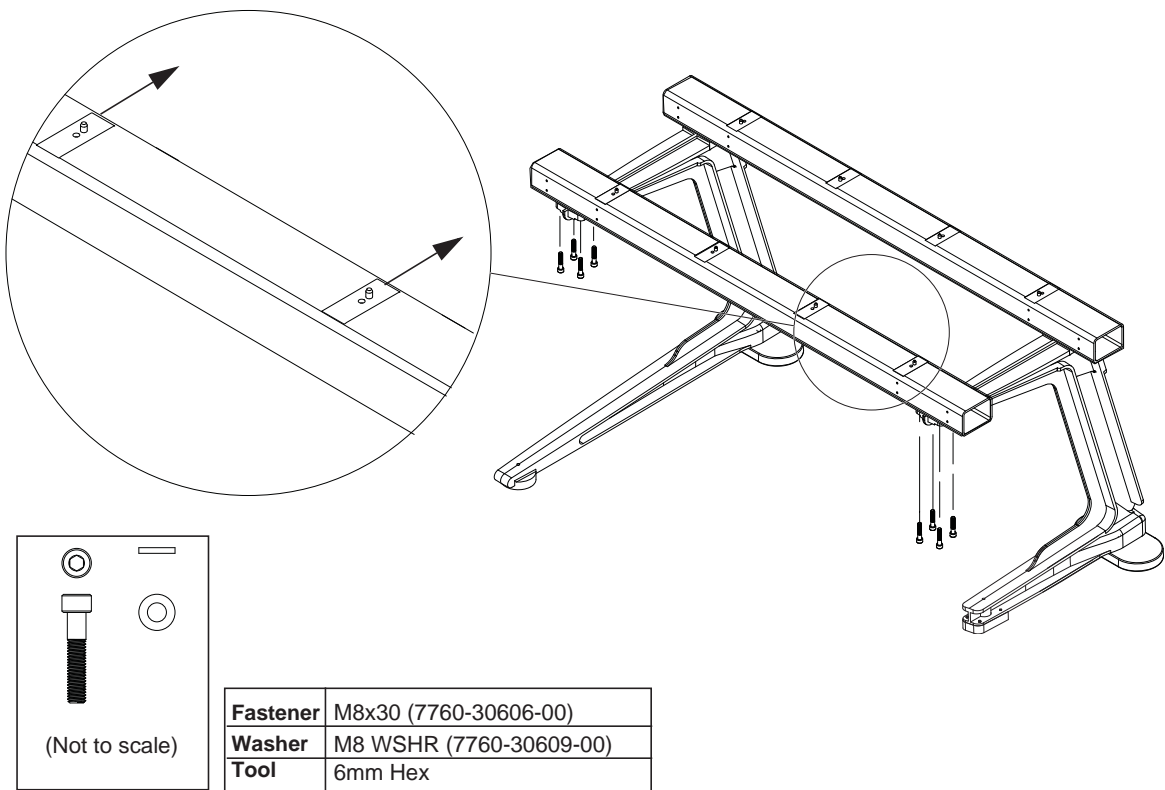

Figure 5. Attaching the front Beam to the Legs of the left frame (orientation of top pins shown at upper left)

Attaching the Back Corner Brackets

To attach the Back Corner Brackets:

- 1 Attach the Back Corner Brackets to the back Beam first, using four fasteners and washers per bracket as shown in Figure 6. Do not tighten the fasteners fully.
- 2 Attach the Back Corner Brackets to the Legs as shown in Figure 6 using four more fasteners and washers (included) per bracket. Align the pins on the brackets with the holes at the top of the Legs. Do not tighten the fasteners fully.

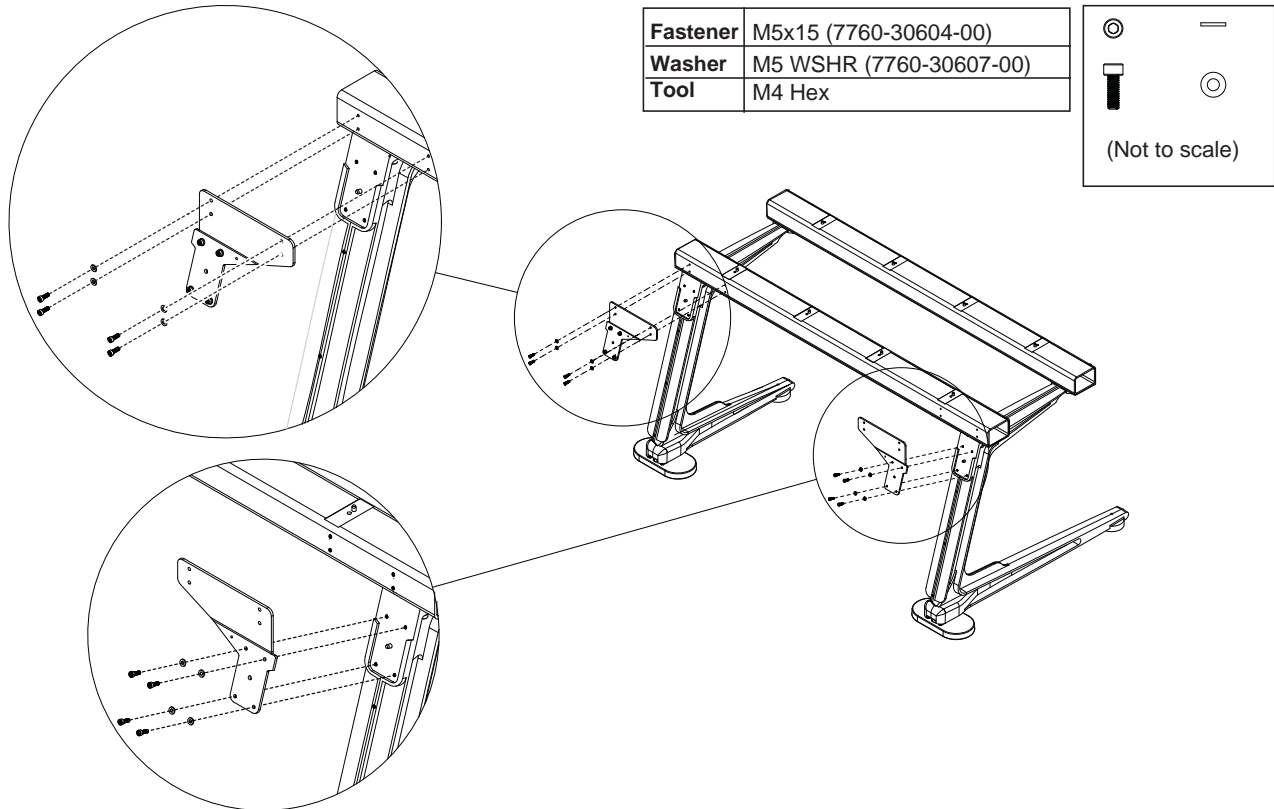



Figure 6. Attaching the Back Corner Brackets (bracket to Beam shown at upper left; bracket to Leg shown at lower left)

Attaching the End Bracket

Attach one End Bracket (7600-31483-00) to the outside end of each Leg Frame.

 If you are joining three frames together, install one End Bracket on the outside end of the far left and far right frame. Do not install an End Bracket on the middle frame.

To attach the End Brackets:

- Using eight fasteners and washers per bracket, attach an End Bracket to the outside end of the Beams (above the standard Leg):
 - When assembling the left frame, attach an End Bracket as shown in Figure 7 (rear view shown). Do not tighten the fasteners fully.

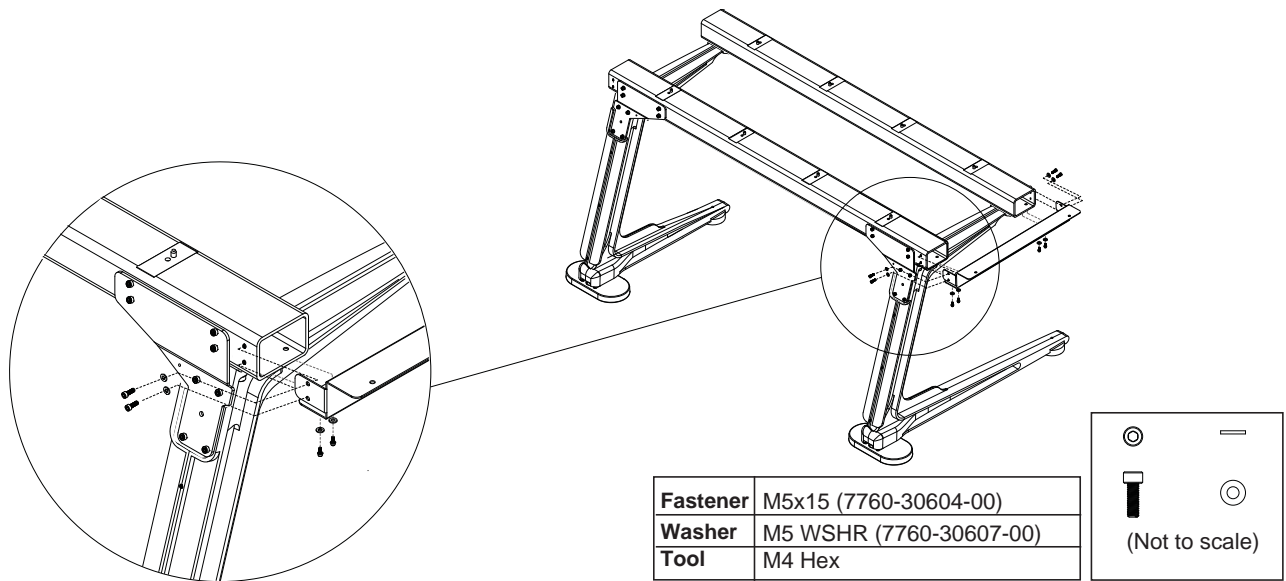

Figure 7. Rear view of attaching the End Bracket to the left frame

- When assembling the right frame, attach an End Bracket as shown in Figure 8 (front view). Do not tighten the fasteners fully.

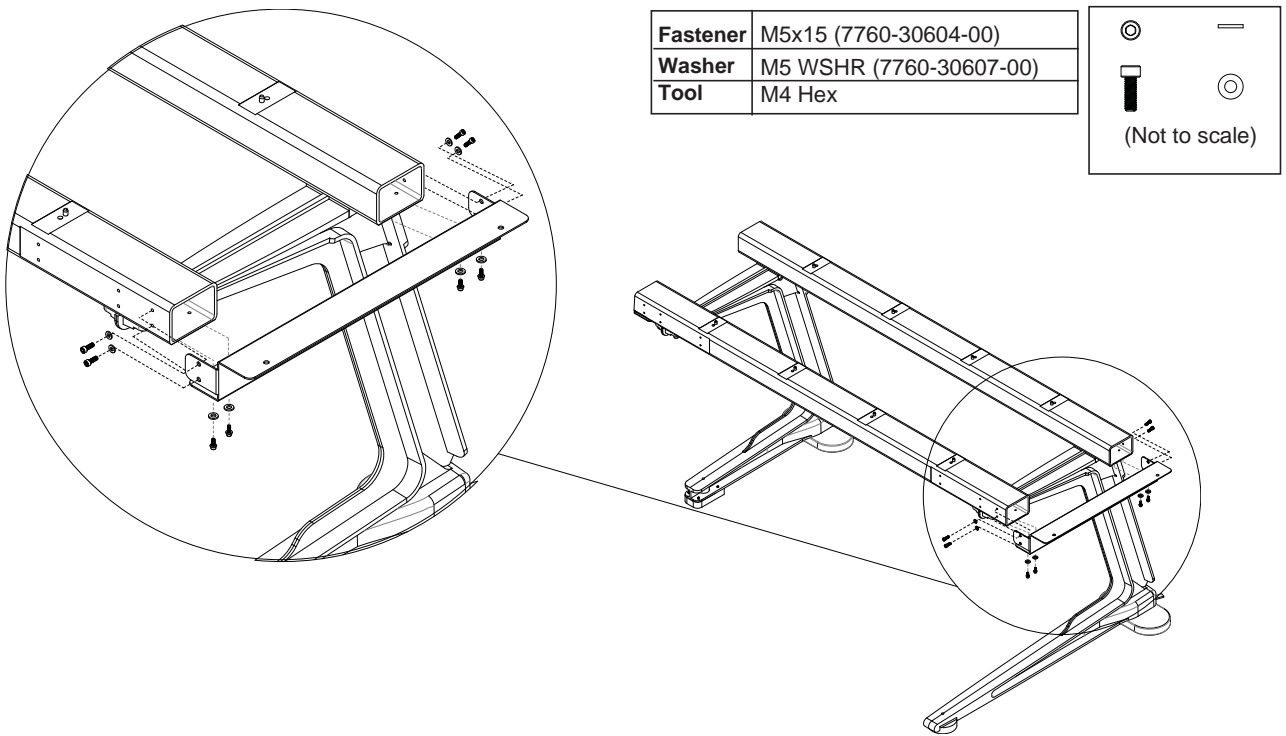

Figure 8. Front view of attaching an End Bracket to the right frame

Leveling the Leg Frames

To level the Leg Frame:

- 1 Start at the back of the frame (either end) and make sure the back Beam sits flat on top of the Leg as shown in Figure 4.
- 2 Starting at either end, place a level (not included) on the top of the Leg between the Beams, or across both Beams directly above the Leg as shown in Figure 9, and determine whether you need to raise or lower the back or front of the Leg.

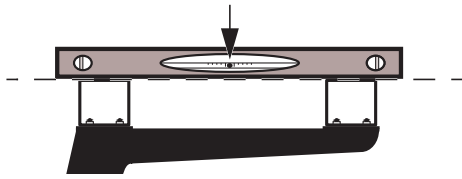

Figure 9. Side view of a level placed across front and back Beams above the left Leg

- 3 Raise or lower the back of the Leg as needed, using the 13 mm open end wrench included with the Legs (see Figure 10). When looking down at the feet from above, turn the wrench clockwise to raise or counterclockwise to lower.

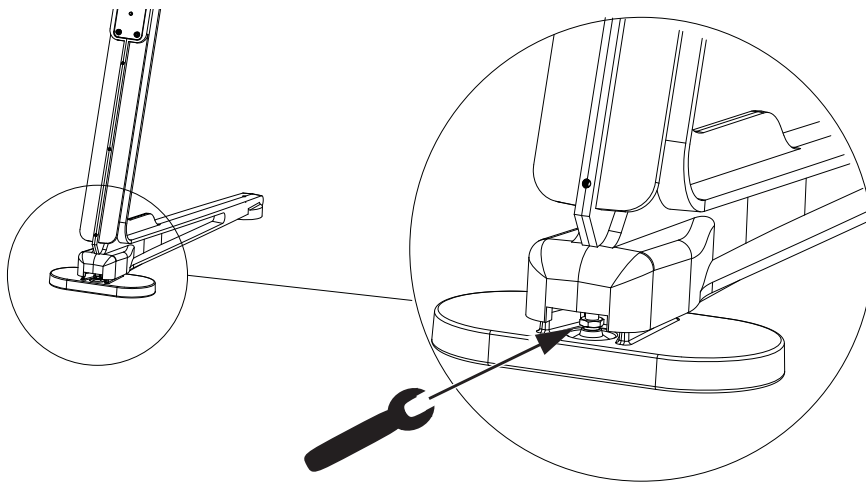

Figure 10. Back Leg Leveler

- 4 To raise or lower the front of the Leg, use an M4 Hex driver to adjust the front leveling feet from above (one M4 Hex is included in the Tool Kit found in the Side Covers package). Turn clockwise to raise, counterclockwise to lower.

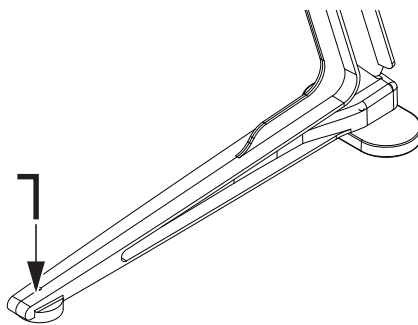

Figure 11. Front leveling foot

- 5 Repeat for the other Legs.
- 6 Lay the level across the front Beam left-to-right (parallel with the Beam) and make sure the left and right Legs are the same height. Adjust the left or right Legs as necessary. Repeat for the back Beam.

Tighten All Fasteners

To complete the Leg Frame assembly:

- 1 At the back of the frame (either end), make sure the Beam sits flat on the Leg and tighten the four fasteners that secure the Beam to the Leg from underneath, then tighten all fasteners of the Back Corner Bracket. Repeat for the other end of the back Beam.
- 2 At the front of the frame (either end) make sure the front Beam sits flat on the Leg, then tighten the four fasteners that secure the Beam to the Leg from underneath. Repeat for the other end of the front Beam.
- 3 Make sure the End Brackets are aligned correctly with the top of the Beams, then fully tighten the bracket fasteners to the Beams.

Assemble the Second Frame

Repeat the previous instructions to assemble the other frame(s). Make sure the standard and center Legs are in the correct positions, and that the End Brackets are installed at the far left and far right ends. In addition:

- While assembling frames, secure components using the included fasteners but do not tighten them fully.
- Level and align the frames.
- After assembling and leveling each frame, tighten all fasteners.

Attach the Frames to Each Other

To attach the frames to each other:

- 1 Place the two frames close to each other, making sure the End Brackets are at opposite ends (the outside ends).
- 2 Attach the Center Bracket (7600-31484-00) to the left end of the right frame using eight fasteners and washers as shown in Figure 12. Do not fully tighten all the fasteners.

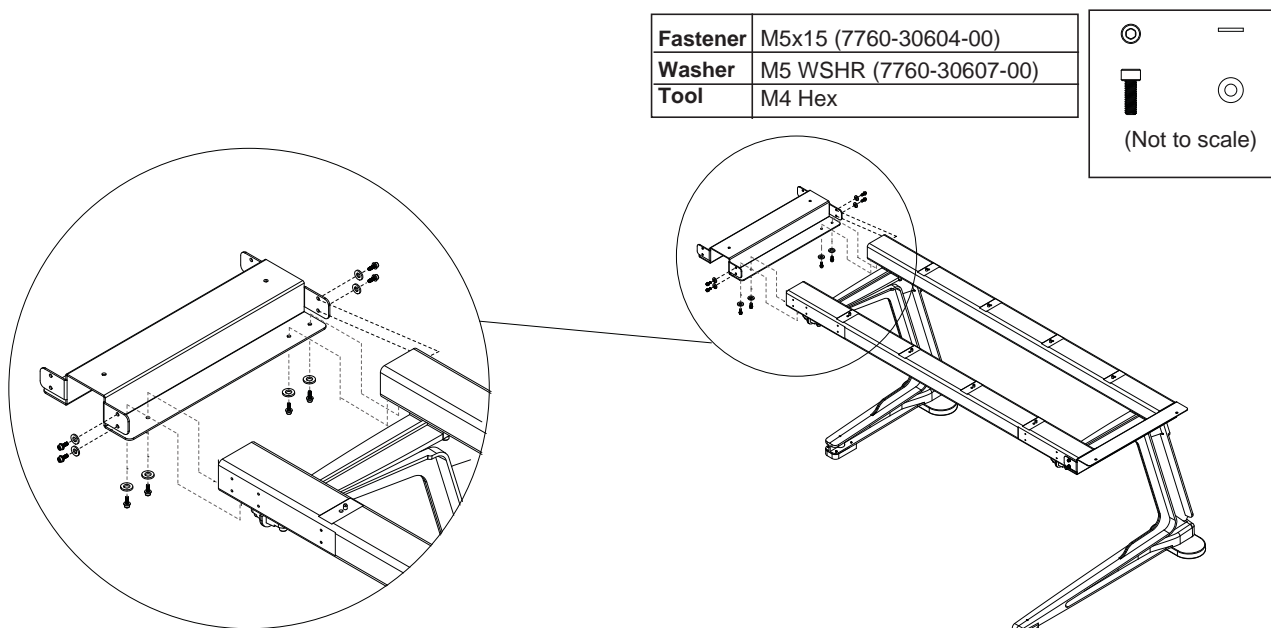

Figure 12. Attaching the Center Bracket to the right frame

- 3 Move the left frame into position so its mounting holes line up with the holes in the Center Bracket. If necessary, raise or lower the frames using the leveling feet.
- 4 Secure the left frame to the bracket using eight more fasteners and washers as shown in Figure 13. Do not fully tighten the fasteners.

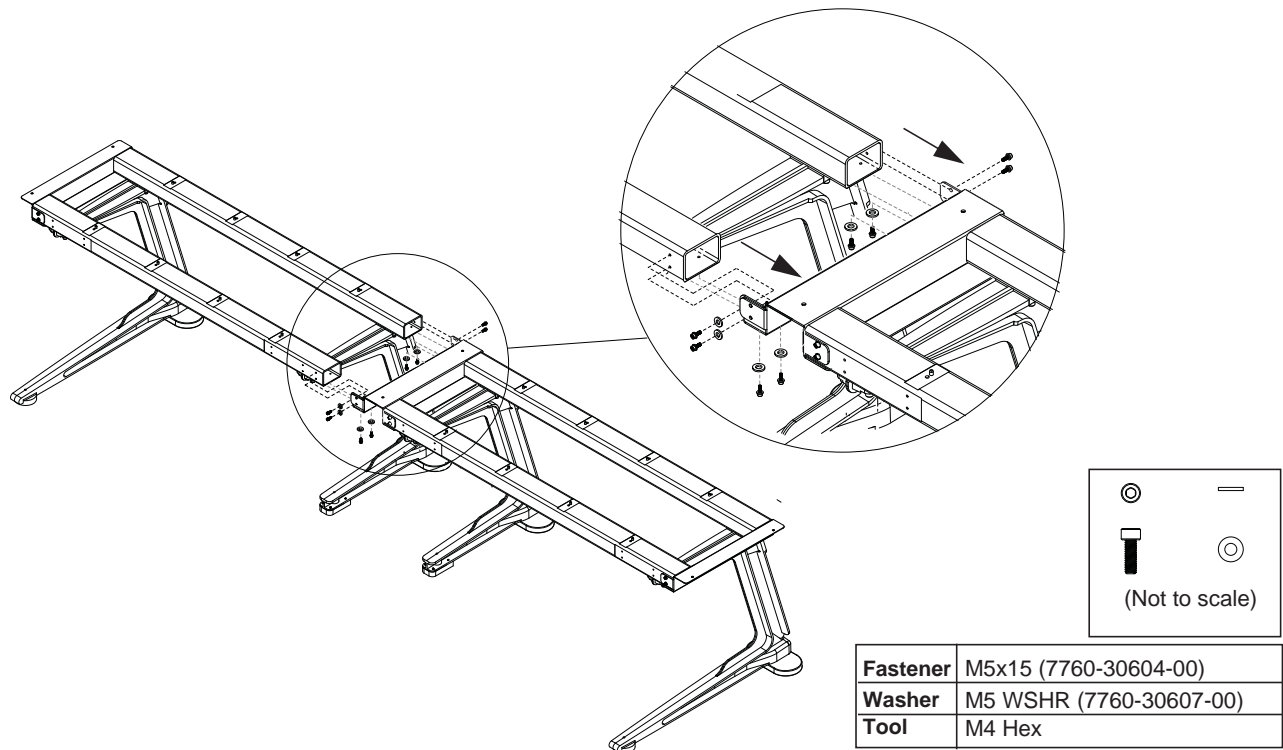

Figure 13. Attaching the left frame to the Center Bracket

- 5 Once the frames and bracket are leveled and aligned, fully tighten all the fasteners.
- 6 If you are assembling three frames, repeat the previous steps to attach the third frame to the first two using another Center Bracket.

How to Proceed

When your Leg Frames are assembled, return to the S6 Installation Guide and continue by following the instructions beginning in Chapter 3 “Assembling Frame Chassis.”



Avid
280 N Bernardo Avenue
Mountain View, CA 94043 USA

Technical Support (USA)
Visit the Online Support Center at
www.avid.com/support

Product Information
For company and product information,
visit us on the web at www.avid.com